



FOR LEASE

1598 South County Trail
East Greenwich, RI 02818

Up to 4,800 SF Available
Lease Price: \$24.50/SF, NNN

Property Highlights

- 60,000 SF CLASS A DEDICATED MEDICAL OFFICE BUILDING
- LOCATED IN HEART OF THE “MEDICAL MILE” IN EAST GREENWICH
- 6/1,000 SF PARKING SUPPORTED BY NEWLY COMPLETED PARKING DECK
- ANCHORED BY **UNIVERSITY ORTHOPEDICS AND COASTAL MEDICAL PRIMARY CARE**
- CUSTOM BUILD-OUTS AVAILABLE
- PROFESSIONAL PROPERTY MANAGEMENT
- EXTERIOR SIGNAGE AVAILABLE

Space Features

- NEW CONSTRUCTION
- FLEXIBLE FOOTPRINT
- LARGE WINDOWS
- COVERED PATIENT DROP-OFF
- TOP QUALITY HVAC SYSTEM, CONNECTIVITY AND FIT-OUT

CLASS “A” MEDICAL



For more information, please contact:

**Pete Hayes, SIOR
Partner**
401.273.7426
phayes@hayessherry.com

**Matt Fair
Senior Vice President**
401.273.2053
mfair@hayessherry.com

146 Westminster Street, 2nd floor
Providence, RI 02903
phone: 401.273.1980
hayessherry.com

FOR LEASE

1598 South County Trail
East Greenwich, RI 02818

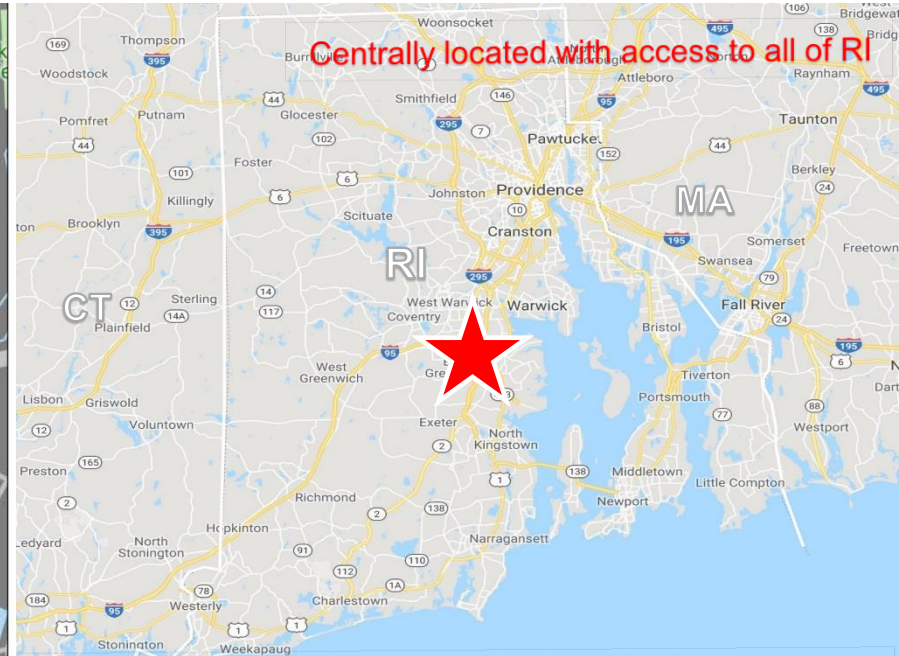

Parking deck allows for easy access and enhanced parking

Parking Deck

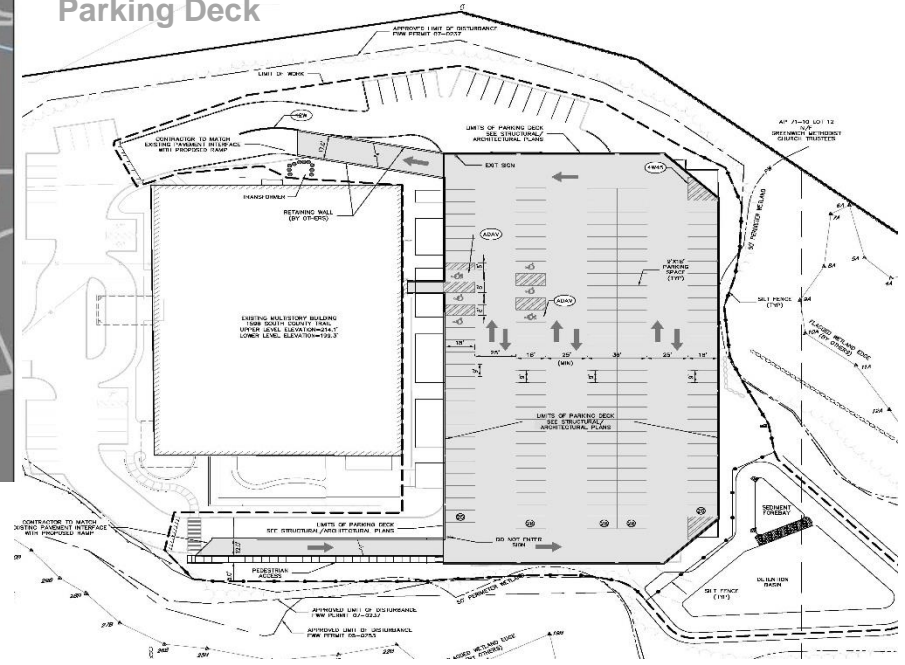

Contact

Pete Hayes, SIOR
Partner
401.273.7426
phayes@hayessherry.com

Matt Fair
Senior Vice President
401.273.2053
mfair@hayessherry.com